

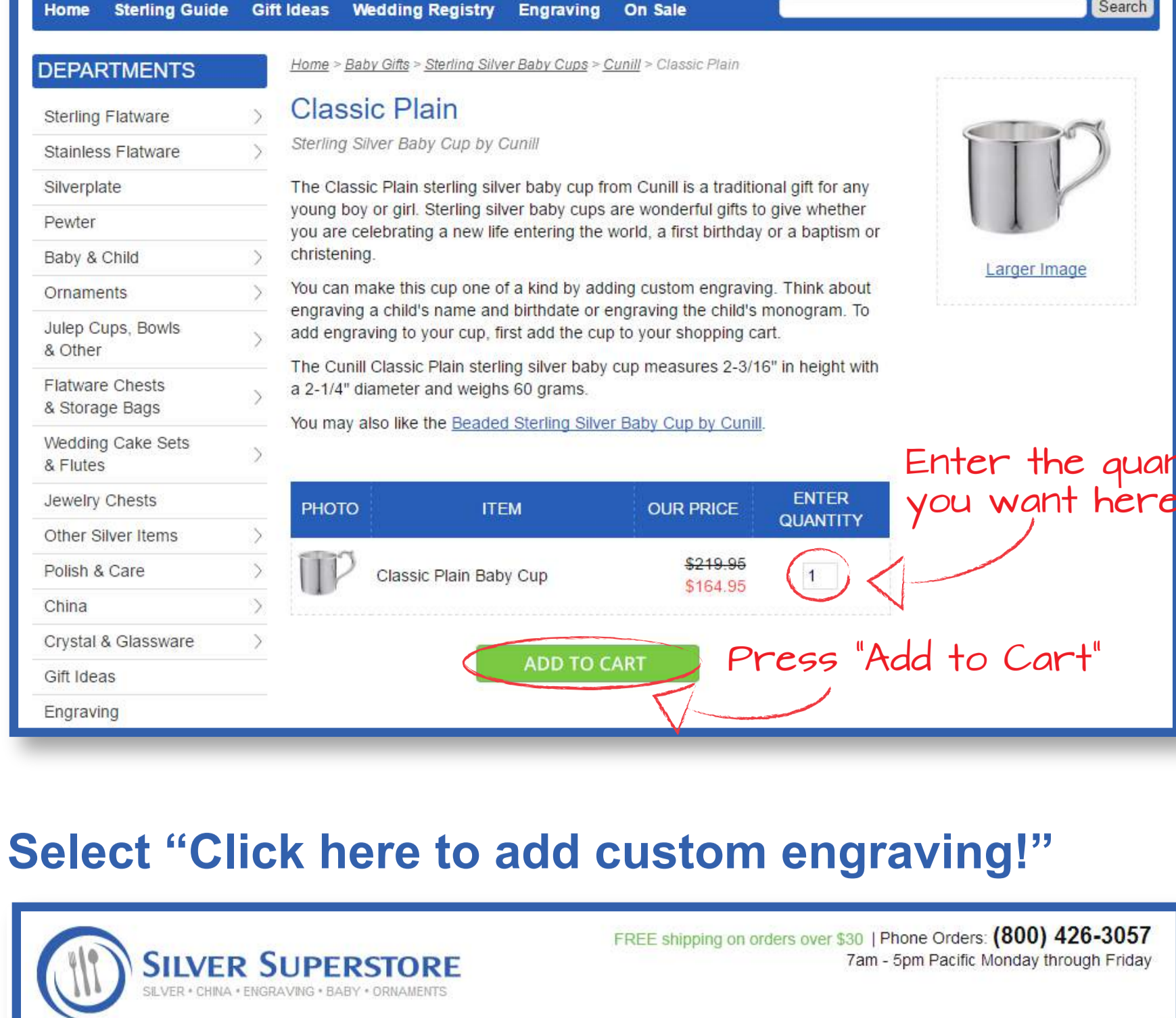

Engraving Personalization Guide

Placing your order

1 Choose an item and add it to your cart.



2 Select "Click here to add custom engraving!"

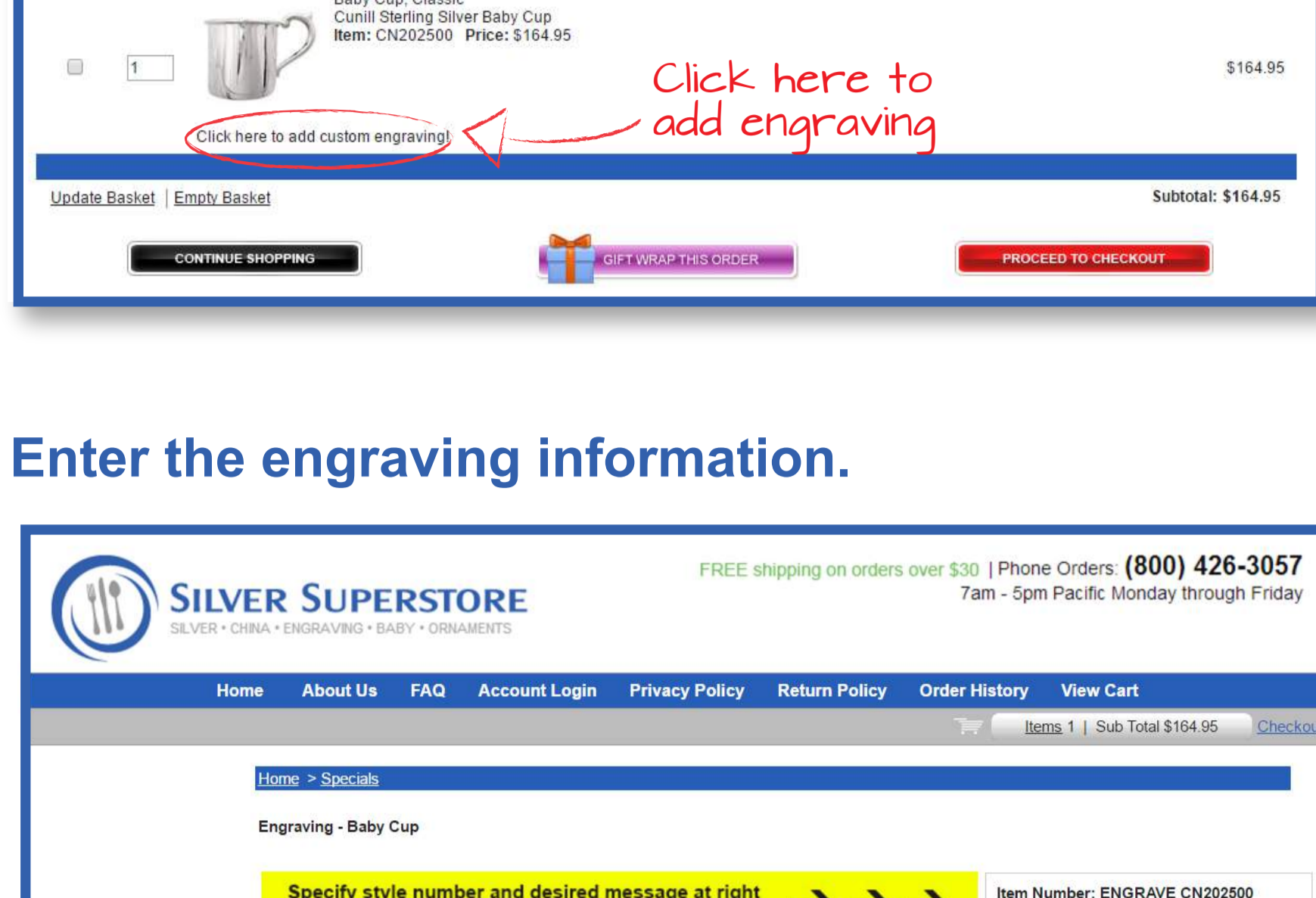

3 Enter the engraving information.



Please include: 1 - style number, 2 - placement and orientation, 3 - if getting a monogram, please include the last name initial, 4 - text to be engraved exactly as you want it engraved, pressing enter/return to separate lines.

Example: Style 410, handle to the left, S from last name
JSM
11.20.99

4 Enter the engraving information.

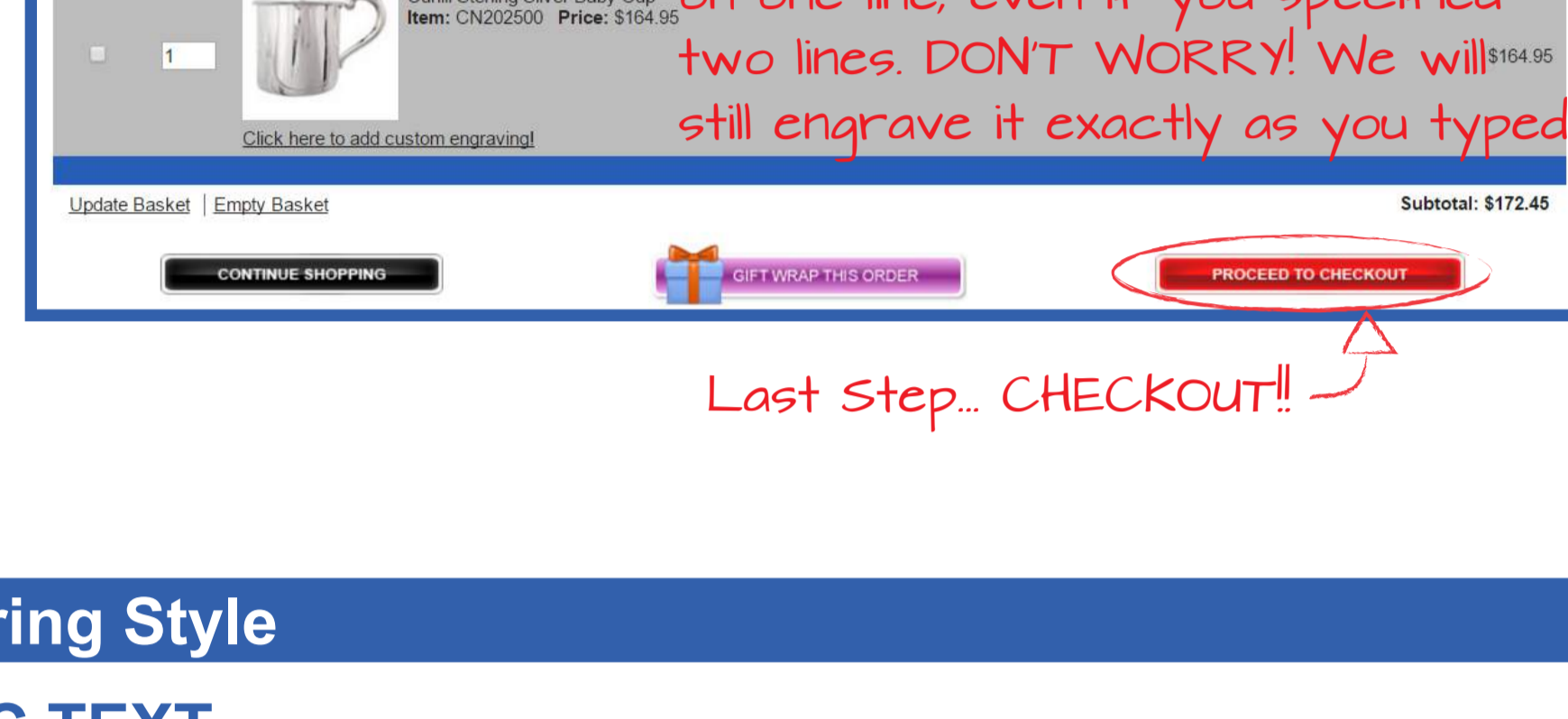

Lettering Style

BASIC TEXT

Names and Plain Text

James

Using a First and Last name to personalize an item is a popular and elegant option. It is often paired with a date below it to memorialize an event.
Example: James

MONOGRAMS

Families and Couples with the Same Last Name

JSD

A traditional 3-letter monogram with the last name initial centered in middle and enlarged, and the couples first initials on either side.
Example: James and Deborah Smith

Families and Couples with Different Last Names

SH

A 2-letter monogram with both letters the same size, in any order you prefer.
Example: James Smith and Deborah Harris

Individuals

JSM

A 3-letter monogram with the last name initial centered in middle and enlarged, and the first name initial on the left and the middle initial on the right.
Example: James Michael Smith

Three Initials

JMS

A 3-letter monogram with all the letters the same size. The order of first, middle, last.
Example: James Michael Smith

Single Initial

S

A single letter monogram, generally the last name initial.
Example: James Michael Smith

Dates

11/20/99

A numerical date is generally the best option for small items, but can be a great option for any engraving. Numbers can be separated by '/', '.', '-', or '-'.

Alphabetically

November 20, 1999

The month is written out, followed by a numerical day and year.

Placement, Orientation and Item Specific Guidelines

Handled Cups

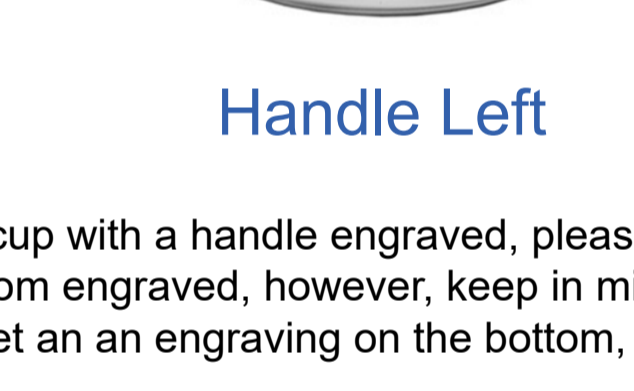

Handle Left

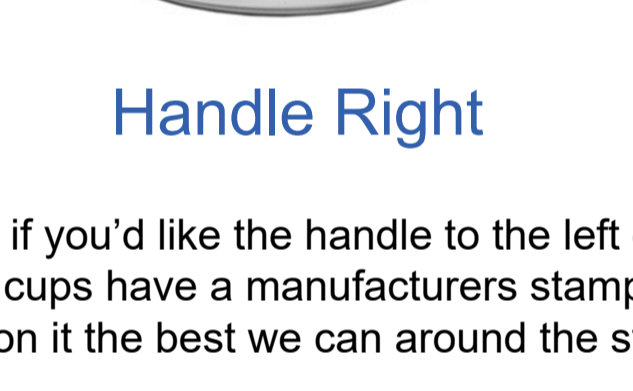

Handle Right



Handle Left

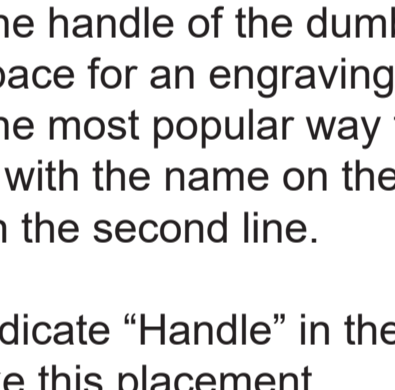

Handle Right

When getting a cup with a handle engraved, please let us know if you'd like the handle to the left or right. You can also get the bottom engraved, however, keep in mind that most cups have a manufacturers stamp on the bottom. If you choose to get an engraving on the bottom, we will position it the best we can around the stamp.

Rattles



Engrave on Handle

The handle of the dumbbell rattle offers the most space for an engraving, allowing two line of text. The most popular way to have the handle engraved is with the name on the first line and the birthdate on the second line.

Indicate "Handle" in the shopping cart if you would like this placement.

Example: Style 310, handle
James
November 20, 1999

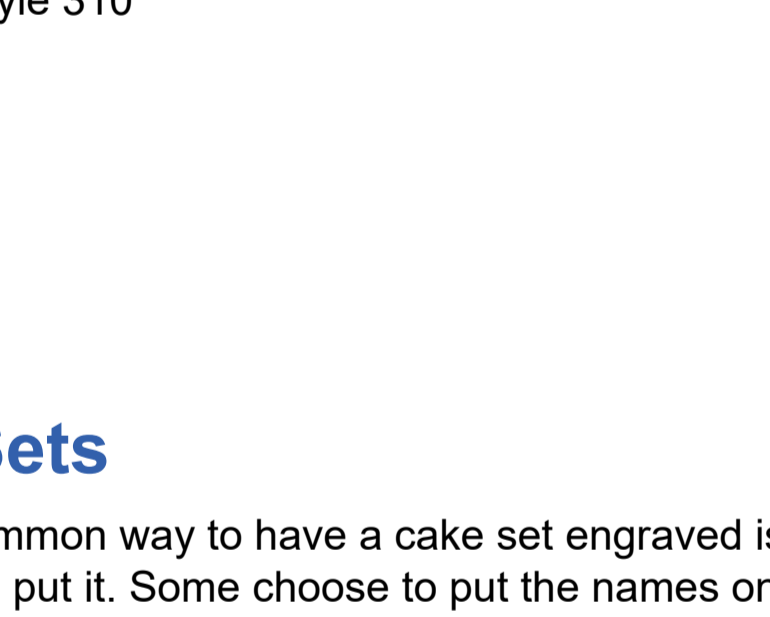

Engrave on End

The ends of the rattle are engravable. However, there is only a small amount of space available for engraving. It is best to keep the engraving to one line, generally a numerical date or short name.

Indicate "End" in the shopping cart if you would like this placement.

Example: Style 310, end
11-20-99

For an additional fee, you can have both the handle and the end engraved. Please indicate in the shopping cart how you would like it engraved.

Example: Style 310
Handle
James
End
11-20-99

Cake Sets

The most common way to have a cake set engraved is with the handle to the right. There are many options of text and where to put it. Some choosing to put the names on the server and the date on the knife, some choose to put names and date on both. Using just the first names is most popular, however, you can also choose to put Mr. and Mrs. and use the last name.



Handle Right (most popular)



Handle Down



Handle Up

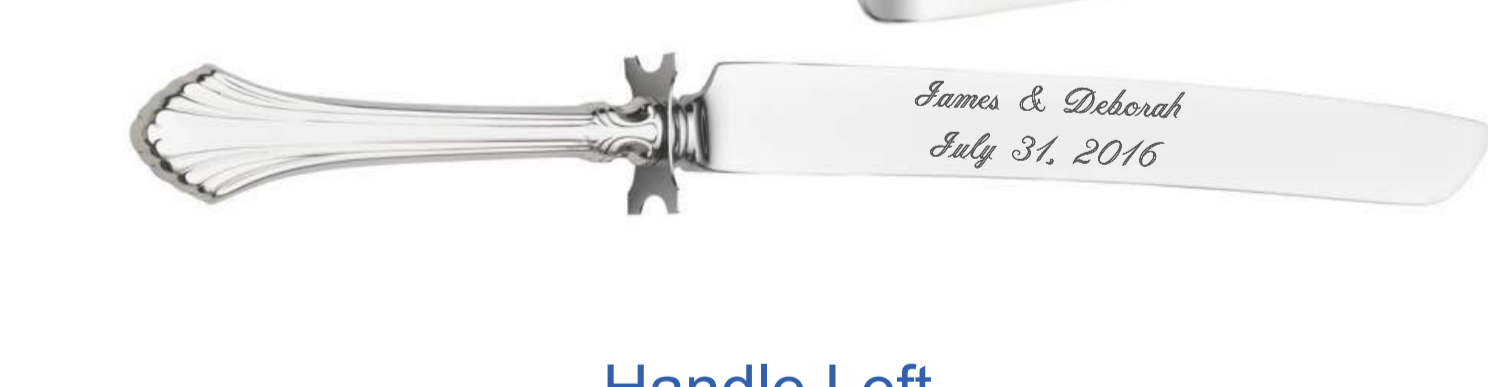

Handle Left

Flatware

The most common way to have flatware engraved is with a single initial on the handle, generally the last name initial. Some people choose to have every piece engraved, some choose to have just the knives engraved, and some choose to have just the serving pieces engraved.



Handle Down



Handle Up



Handle Right



Handle Left

Basic Font Styles

James
Style 310
(Text, Initials)

JAMES
Style 323
(Text, Initials)

Deborah
Style 337
(Text)

Deborah
Style 366
(Text, Initials, Monograms)

JSM
Style 22
(3 Letter Monograms only)

JSM
Style 410
(Monograms)

JSM
Style 356
(1 or 3 Letter Monograms)

James
Style 500
(Text)

Deborah
Style 520
(Text)

James
Style 330
(Text, Initials, Monograms)

Smith
Style 540
(Text)

Smith
Style 510
(Text)

JAMES
Style 550
(Text)

JAMES
Style 530
(Text)

If you have any questions while placing your order, please call us at 1 (800) 426-3057.